

SureStrike™

Shotgun



LASER AMMO
TRAINING TECHNOLOGIES

The SureStrike™ allows you to train with your Shotgun in complete safety at any location without using live ammunition. This high quality tool provides a safe, realistic and economical training environment for all user levels.

- 12G Adapter
- 20G Adapter
- 12G Hunting pack
- 20G Hunting pack

BE A BETTER SHOT
Spend less effort, time, and money on training!

Whether novice or expert, practice with today's best personal training system ANYTIME, ANYWHERE.

Product of Laser Ammo USA Inc.
Phone: 516-858-1262

♻️ Made in Israel
🇺🇸 Assembled in the USA

CAUTION

LASER RADIATION:
avoid eye or skin exposure
to direct or scattered radiation

- ☑️ 630-660nm Output Power < 5mW
Class 3R Laser Radiation
- ☑️ 780nm IR Output Power < 5mW
Class 1 Laser Radiation
- ☑️ 635nm Output Power < 1mW
Class 1 Laser Radiation



8 54855 00305 7
012AR



This Product is patented under the United States Patents. The user is hereby placed on notice of Laser Ammo rights as listed on www.laser-ammo.com.

Shotgun

SureStrike™

Shotgun





ACCURACY



FIRING PIN
ACTIVATED



NO VIBRATION
SENSITIVITY

• Marksmanship • Speed • Tracing • Trigger pull

Instructions

Step 1 - Safety

- Unload the weapon
- Physically and visually inspect the chamber, bore, and magazine to ensure that all ammunition has been removed.
- Store ammunition in an area that is separate from your training area.

⚠ Always personally verify that all ammunition has been removed before training.

Do not allow any live ammunition in the training area.

WARNING: Failure to follow safety instructions may result in injury or death.

- It is recommended to lightly lubricate the adapter's o-ring before use.

Step 2 - Installation

- 1 - Open the Shotgun Adapter by unscrewing the adapter cap. Insert the cartridge into the body of the adapter and reassemble the adapter by screwing the cap back on and tightening gently.
- 2 - Open the chamber of the shotgun, insert the Shotgun adapter as you would insert a single cartridge.
- Using your finger or the back end of a pencil, rotate the adapter and align the grooves on the adapter's cap to be positioned in the chamber so that the weapon's extractor will NOT come in contact with the adapter while cycling.

Step 3 - Removal

- 3 - Open the chamber.
- 4 - Using your finger or the back end of a pencil, rotate the Shotgun Adapter by pushing the grooves on the adapter's cap until it is aligned in the chamber so that the weapon's extractor WILL come in contact with the adapter's rim.
 - Cycle the weapon over a soft surface to eject the adapter.
 - Remove the Laser Bullet from the adapter.
 - Remove the battery from the laser cartridge when not in use.

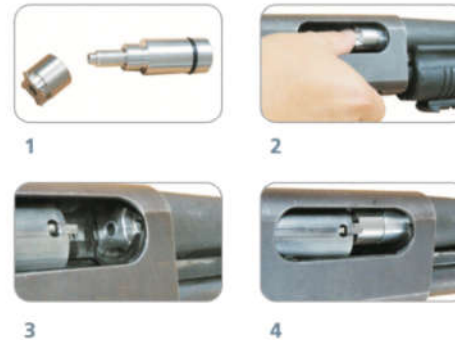

Full set of video instructions is available at:
www.laser-ammo.com

All firearms are potentially dangerous and can cause great harm, personal injury and death. It is your responsibility and legal obligation to handle, load, unload, use, transport, maintain, and store your firearm in a safe manner. No liability is expressed or implied for damage or injury as a result of installation or use of this product. Warranty is limited to the replacement or repair of the original product only.

Shotgun