

# ADVANCED TRAINING LASER PISTOL (ATLP) (SF25 MODEL) USER GUIDE

The ATLP comes from the factory in a **SHOT MODE** only! Please refer to this user guide to activate the sensors.

**WARNING:** Devices are weighted for realistic handling. Striking a person with this device can result in serious injury or death.

**WARNING:** Device does not replace professional firearms instruction.

**WARNING:** Both device itself and magazine contain inaccessible **LEAD** weights. If device/magazine is damaged do not handle lead and contact Smart Firearms Training Devices.

## 1. General Information

The Advance Training Laser Pistol (ATLP) is designed to teach proper firearms handling skills. The device distinguishes between deliberate actions and unintentional incursion(s) into the trigger guard. When an unintentional intrusion is detected an alarm will sound and two LEDs along the side of the frame will flash. The alarm stops immediately when incursion is no longer detected, the LEDs remain flashing for 9 seconds. "SHOT ONLY" (section 4.2) mode removes the intrusion detection while keeping the trigger enabled. By using the ATLP with the Laser cartridge the user can train with this advanced training pistol, together with Laser Ammo electronic targets, simulators and training software, for more enhanced training.

## 2. Package Contains:

- |                                    |  |
|------------------------------------|--|
| 1. ATLP Model SF25 Training Device | 5. LASER-AMMO optical cartridge (Red or IR)  |
| 2. Adjustable sights (Optional)    | 6. Blue Battery pack for the laser cartridge |
| 3. Removable Magazine (optional)   | 7. Two 3V CR123A Batteries (installed)       |
| 4. Allen wrench                    |  |

## 3. Parts List

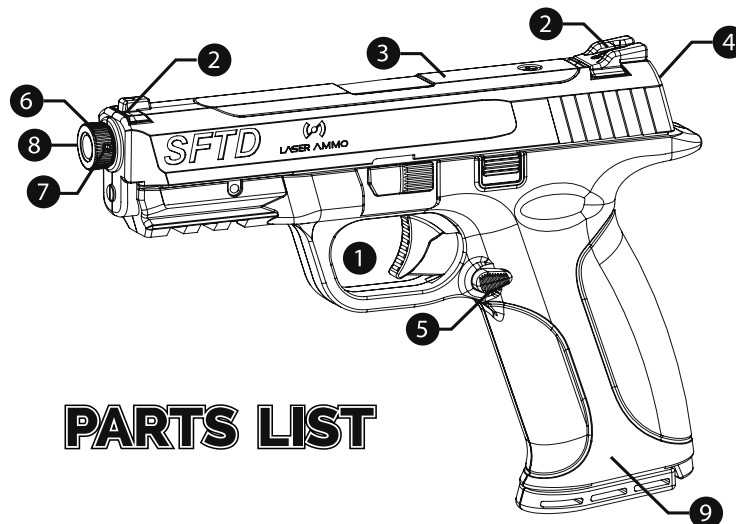

### PARTS LIST

- |   |                               |
|---|-------------------------------|
| 1 | TRIGGER/TRIGGER GUARD         |
| 2 | ADJUSTABLE SIGHTS             |
| 3 | BATTERY COVER                 |
| 4 | SPEAKER                       |
| 5 | AMBIDEXTROUS MAGAZINE RELEASE |
| 6 | FRONT RETAINER                |
| 7 | ADJUSTMENT SCREWS             |
| 8 | OPTIC LASER CARTRIDGE         |
| 9 | ALLEN-WRENCH STORAGE          |



## 4. Introduction

### 4.1 Activation

THE ATLP MODEL SF25 ARRIVES FROM THE FACTORY IN A “SHOT ONLY MODE”. TO ACTIVATE THE ACCIDENTAL DISCHARGE SENSOR, PULL AND HOLD TRIGGER FULL AFT FOR 9 SECONDS. GUN WILL CHIRP AND EMIT AN AMBER LED. RELEASE TRIGGER. GUN IS NOW IN START-UP MODE. KEEP TRIGGER GUARD AREA CLEAR. GUN WILL CONTINUE TO CHIRP AND EMIT AMBER LEDS FOR APPROXIMATELY 45 SECONDS. GUN WILL THEN BE FULLY FUNCTIONAL.

To verify the device is working place a finger in the trigger guard resulting in an intrusion alarm. After a successful intrusion alarm, pull trigger to verify “SHOT” sound.

If either feature is inoperative continue to TROUBLE SHOOTING SECTION 6.

### 4.2 Shot only mode

The ATLP arrives from the factory in “Shot only mode”. If the ATLP was activated as mentioned in 4.1 and the intrusion alert is not desired, and user would like to move back to Shot Only Mode, please follow the 2 steps:

- A. To enter mode, hold trigger full aft for 9 seconds. The gun will emit 2 chirps along with 2 flashing green LEDs.
- B. To disable mode, hold trigger full aft for 9 seconds. Release trigger when gun emits a chirp. Gun will continue to chirp and flash amber LEDs. Keep trigger guard clear until both chirping and LEDs cease.

### 4.3 Battery

The ATLP Model SF25 utilizes two 3V CR123A lithium batteries. These batteries should last approximately 14 weeks in an active defensive tactics environment or up to a year in low use.

To change batteries, remove the Philips head screw at the rear of the battery cover and remove cover.

Upon battery replacement gun defaults to “SHOT ONLY” mode. To restore full function, see SHOT ONLY (4.2)

When the batteries are nearly depleted, device will emit a short chirp every five minutes and a red LED will flash every minute. It is important to change the battery at this time as the device will not function correctly on depleted batteries.



## 5. Laser Ammo Optical Cartridge

The Laser-Ammo Optical cartridge is screwed into the barrel of the ATLP Model SF25. Pulling the trigger will pulse the laser.

Optic laser



Front retainer and adjustment screws

### 5.1 Setting windage and elevation:

The retainer has 4 adjustment screws for aligning the laser. The ones on the sides are used for windage, and the top and bottom are for elevation.

Holding your ATLP, fire at your target from the distance you would normally practice at.

Referring to directions as viewed by holding the ATLP muzzle away, the adjustment is made by screwing out the screw opposite the direction you hit the target, and screwing in the other side.

For example:

If the shot is to the left of the target, slightly screw out the screw on the right and screw in the screw on the left. If the shot is high of the target, slightly screw out the screw on the bottom and screw in the screw on the top.

**Make sure you start by opening a screw first to allow the cartridge to move as you close the other side.**

Once the ATLP is sighted, do not over tighten the adjustment screws! They only need to be snug.

When installed correctly the windage screws will be on the sides and the elevation screws on the top and bottom of the laser cartridge adapter.

### 5.2 Disassembly and battery change:

1. Unscrew the retainer (together with the Laser Cartridge) from the ATLP. Do not open the cartridge windage or elevation screws. The laser cartridge can stay in the front retainer to keep the settings.
2. Remove the cap on the cartridge and insert the battery flat side +, facing up.
3. Take the optic cap and thread it onto the laser body. Verify the threading is fully closed and that there is no gap. Close snugly, do not over tighten.
4. Install the retainer with Laser cartridge in the ATLP housing. Thread the retainer all the way down, then move it back slightly until the Allen screws will be facing up / down left / right.

### 5.3 Maintenance:

The Optic cartridge is an electronic device and should always be treated as such.

Wipe the Laser cartridge only with a soft fabric - do not immerse in solvents or cleaning agents.

Clean the laser lens using a glass cleaner and cotton swab.

Take out battery when not in use.

## 6. Troubleshooting

### 6.1 The device has been immersed in water and doesn't function

- Remove the batteries
- Allow device to dry completely

### 6.2 The sensor is over sensitive (Alarms in holster or during a normal, safe grip)

- Pull trigger and hold
- After 9 nine seconds, device will go into "shot only"
- Pull trigger and hold again for 9 seconds. Device will now go into start-up mode
- Place pinky finger in the lower forward part of trigger guard. Do not remove finger until start-up is complete.

NOTE: Devices are configured for duty holsters; certain concealment holsters may cause over sensitivity.

### 6.3 The sensor under sensitive (Doesn't alarm with finger in trigger guard)

- Pull trigger and hold
- After 9 seconds device will go into "shot only"
- Pull trigger and hold again for 9 seconds. Device will now go into start-up mode
- After start-up proper sensitivity should be restored.

### 6.4 Device is silent (no alarms or "shot" sound) but LED light functions continue to function

- Speaker is inoperative. Please return to Smart Firearms Training Devices for replacement.

### 6.5 Device is too loose/snug in holster

- Devices are designed to fit the most popular duty holsters on the market. The majority of duty holsters have adjustment screws to loosen or tighten the holster.

### 6.6 Device continues to go into start-up mode or flashes RED LED

- Electronic components may be damaged, normally from high impact forces.
- Remove and reinstall the batteries.
- After start-up test the device. If problem persists, call customer support.

## 7. Customer Support

For any gun related issues please visit customer support link at [WWW.SMARTFIREARMS.US](http://WWW.SMARTFIREARMS.US).

For any Laser related issues please email: [SUPPORT@LASER-AMMO.com](mailto:SUPPORT@LASER-AMMO.com) or call: (516)858-1262

## 8. WARRANTY

SFTD PROVIDES A ONE YEAR PARTS AND LABOR WARRANTY ON THE ATLP GUN AND LASER AMMO USA INC PROVIDES A ONE YEAR PARTS AND LABOR WARRANTY ON THE OPTIC LASER CARTRIDGE (TOGETHER: "THE DEVICE"). ANY OPERATION OF THE DEVICE OUTSIDE OF ITS INTENDED USE VOIDS THE WARRANTY. THE DEVICE IS NOT TO BE SUBMERGED IN WATER. THE DEVICE IS NOT TO BE DROPPED FROM A HEIGHT OF OVER FOUR FEET ONTO A HARD SURFACE. ANY MODIFICATION TO ANY ELECTRONIC COMPONENT VOIDS THE WARRANTY.

### **LASER AMMO USA INC**

PO BOX 222017

GREAT NECK, NY 11021

TELL: (516)858-1262

EMAIL: [Info@laser-ammo.com](mailto:Info@laser-ammo.com)

WEB: [www.laser-ammo.com](http://www.laser-ammo.com)

### **SMART FIREARMS TRAINING DEVICES**

821 EAST SUNBURST IN

TEMPE, ARIZONA, 85284

TELL: (602)690-0513

EMAIL: [mike@smartfirearms.us](mailto:mike@smartfirearms.us)

WEB: [www.smartfirearms.us](http://www.smartfirearms.us)